

User Manual

Model: Breezy Blue Response (SKU: BBR01)

With Bluetooth® Wireless Technology



Manufacturer and Contact Information

Manufacturer: Build With Robots

Address: 429 Commercial Street NE
Albuquerque, NM 87102

For product information, sales, service, and technical support:

<https://buildwithrobots.com/>

Customer Support Phone: (833) 273-3991

Email: info@buildwithrobots.com

This manual covers model: Breezy Blue Response (BBR01)

SPECIFICATIONS:

Voltage: 110-120 VAC

Watts: 1080 W



Amps: 9.0 A

Hertz: 50-60 Hz



Safety Symbols

These symbols and terms may appear on the product and in this user manual:

	Refer to the user manual for warning information to avoid hazard or personal injury and prevent damage to device.
	Alternating current (AC)
CAUTION	CAUTION indicates an imminently hazardous situation which, if not avoided, may result in minor or moderate injury, or product damage.
WARNING	WARNING indicates a hazardous situation which, if not avoided, could result in death or serious injury.



General Safety Summary

Review the following safety precautions to avoid injury and prevent damage to this product.

To avoid potential hazards or harm, use this product only as specified.

Failure to comply with the precautions and warnings in this manual violates the safety standards of the design, and the intended use of the product. The manufacturer assumes no liability for harm of persons or damage of property due to the customer's failure to comply with these requirements as the protection provided by the product may be impaired.

To avoid fire or personal injury:

Use proper power cord. Use only the power cord specified for this product and certified for the country of use.

Do not use the provided power cord for other products.

Ground the product. This product is grounded through the grounding conductor of the power cord. To avoid electric shock, the grounding conductor must be connected to earth ground.

Do not disable the power cord grounding connection.

Observe all ratings. To avoid fire or shock hazard, observe all ratings and markings on the product.

Power disconnect. The power cord disconnects the product from the power source. See Product Overview for the location. Do not position equipment so that it is difficult to disconnect the power cord; it must always remain accessible to the user to allow for quick disconnection if needed.



Do not operate without covers. Do not operate this product with covers or panels removed.

Avoid exposed circuitry. Do not touch exposed connections and components when power is present.

Do not operate with suspected failures. If you suspect that there is damage to this product, have it inspected by qualified service personnel.

Disable the product if it is damaged. Do not use the product if it is damaged or operates incorrectly. If there is doubt about the safety of the product, turn it off and disconnect the power cord. Clearly mark the product to prevent its further operation.

Examine the exterior of the product before use. Look for cracks or missing pieces.

Do not operate in wet/damp conditions.

Do not operate in an explosive atmosphere.

Do not operate while moving. Breezy Blue is intended to be operated in a stationary, level position.

Provide a safe working environment. Always place the product in a location convenient for viewing the button or waist-light status indicators.

Place the product where it would not be easily overturned.

Use care when lifting and carrying the product. This product is provided with a handle for lifting and carrying.



Use only BWR-approved solution in the product. Read and understand all safety and operational documentation for solution. Consult the safety data sheet and follow the recommended safety precautions when handling the solution and fogging.

Stay clear of area being treated while in use. Keep the room, vehicle, or immediate area to be treated clear of people, animals, food, etc. while device is in use and the fog is settling.

Avoid excess sound exposure. The device can produce sound levels greater than 80dBA while fogging. Be sure to wear appropriate hearing protection as needed and fog areas when there are no people present.

Keep product surfaces clean and dry.

Provide proper ventilation. To ensure the product functions as intended, keep the rear of device clear of obstructions.



Environmental Considerations

This section provides information about the environmental impact of the product.

Product End-of-Life Handling

Observe the following guidelines when recycling an instrument or component:

Equipment recycling. Production of this device required the extraction and use of natural resources. The device may contain substances that could be harmful to the environment or human health if improperly handled at the product's end of life. To avoid the release of such substances into the environment and to reduce the use of natural resources, we encourage you to recycle this product in an appropriate system that will ensure that most of the materials are reused or recycled appropriately. It is recommended that this device be taken to a certified Waste Electronic and Electrical Equipment recycler.

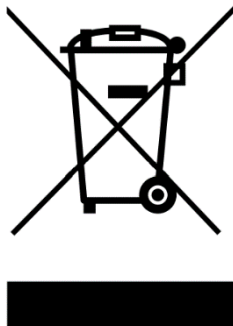

Do not throw in trash at end of product life.



Contents

Manufacturer and Contact Information	2
Safety Symbols	3
General Safety Summary	4
Environmental Considerations	7
Preface	11
Where to find more information	11
General Information	12
Service Information	13
Before Unpacking	13
Contents Included:	13
Getting Started	15
Operating Requirements	15
Power Supply Requirements	16
Cleaning	16
Powering the Device ON and OFF	17
Functions and Operating Descriptions	18
Default Factory Settings	18
Push Button Operation	18
BB01-WC Wireless Controller Setup (Not included with Breezy Blue Response)	20
Controller navigation overview	20
Connecting to Wi-Fi	21
Setting screen timeout (optional)	22
Setting lock screen PIN (optional)	23
Updating Android Kiosk PIN for Wi-Fi and settings (optional)	24
Log-in	25
Main Screen Overview	26
Pairing	27
Unpairing	28
Status Tab	29
Config Tab	30



Alias Button	30
Duration Button	31
Schedule Button	33
Update Tab	36
Remote Controlled Operation.....	37
Approved BWR Solutions.....	38
Fill Port Instructions.....	38
Filling the Solution Tank from Empty	38
Filling the Solution Tank When Solution Level is Low	39
Emptying the Solution Tank.....	39
Troubleshooting	40
Maintenance.....	41
LIMITED WARRANTY (USA/CANADA).....	42

Keep this user manual in a readily accessible location



List of Figures

Figure 1: Overview of Breezy Blue Response device. Top/side view (left) and bottom view (right)..... 14

Figure 2: Power Breezy Blue Response on and off (electrical inputs)..... 17

List of Tables

Table 1: General features for Breezy Blue Response 12

Table 2: Environmental Specifications for Breezy Blue Response 15

Table 3: Power Specifications for Breezy Blue Response 16

Table 4: States and Status Indicators for Breezy Blue Response 19

Table 5: Breezy Blue Troubleshooting..... 40

Table 6: Breezy Blue Scheduled Maintenance 41



Preface

This manual describes the setup and operation of Build With Robots automated fogging technology. The following device is supported by this manual:

Breezy Blue Response

Where to find more information

Item	Purpose	Location
Safety and Compliance Instructions	Safety, Compliance, and Basic Startup	Printed Copy in Box https://buildwithrobots.com/breezyblue
User Manual	Unpacking, Installation, Settings, and Operation	https://buildwithrobots.com/breezyblue



General Information

The Build With Robots Breezy Blue™ Response is a self-contained, portable, and remote controlled cold fog dispensing system. Compatible with Build With Robots approved solutions, Breezy Blue Response can eliminate dangerous pathogens and organisms. Breezy Blue also collects and presents data to assure that your space has been thoroughly and properly treated.

Table 1: General features for Breezy Blue Response

Item	Specification
SKU	BBR01
Approved BWR Solutions	Breezy BioCare RTU™
Settling time	10 minutes (see solution instructions)
Tank capacity	4.7 L (1.25 gal)
Particle Diameter	20 um to 100 um
Fogger	Atomizing Cold fogger, 20 µm to 100 µm particles
Language	English
Connectivity	Bluetooth® Low Energy v5.2
Remote controller (up to 100 ft.)	Breezy Smart Controller (BB01-WC, sold separately)
Remote configuration	Status, Fogging Duration, Countdown Duration, Scheduling, Fluid Level, Alias
Visual indicators	Idle, Fog Countdown, Fogging, Fog Settling, Disabled
Audible indicator	Fog Countdown
Safety Feature	Fogger disable switch
User controls (via push button)	Delayed Turn-On or Immediate Off
AC power	110-120VAC / 50-60 Hz, 9.0A (while fogging)
Size and Weight	Diameter - 31.8 cm (12.5 in), Height - 41.9 cm (16.5 in), Weight - 10.9kg (24 lbs.) full of fluid
Portability	Handle for carrying and cord wrap



Service Information

The product contains no serviceable parts and should not be disassembled, repaired, or modified by anyone other than the manufacturer or approved technicians.

Before Unpacking

Inspect the package carton for external damage. If the carton is damaged, notify the carrier.

Remove the device from its package and check that it has not been damaged in transit. Verify that the carton contains the device and contents listed below.

Contents Included:

- **1 x Safety and Compliance Instructions (printed)**
- **1 x AC power cord**
- **1 x Breezy Blue Response**

The appearance or components of the product may differ depending on the model. If anything is missing, please contact Build With Robots.



Product Overview

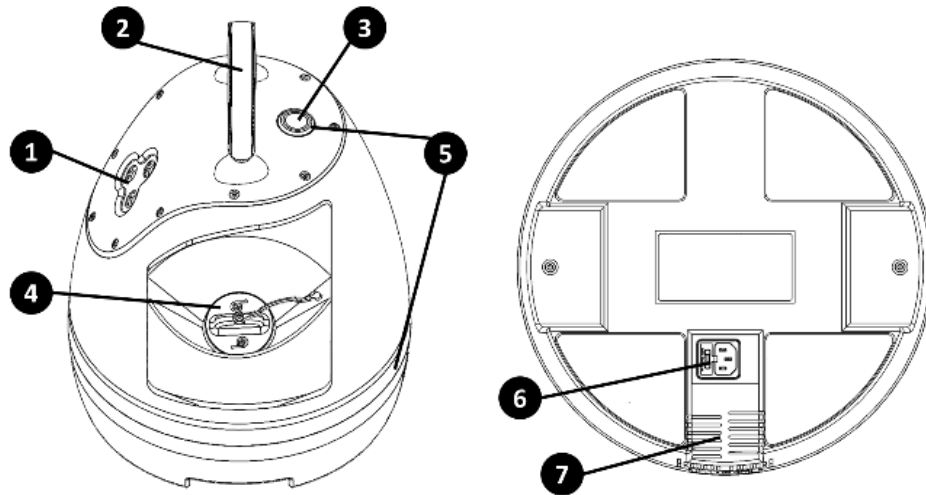

Figure 1: Overview of Breezy Blue Response device. Top/side view (left) and bottom view (right).

1. Fog outlet
2. Handle
3. Fogger enable/disable button
4. Fill port cap
5. Status lights (waist and button)
6. Power connector
7. Air intake



Getting Started

Operating Requirements

Install the device in a location meeting the following guidelines:

- Rear clearance: 5 cm (2 inches) or greater
- Recommended Height from ceiling: 1.2 m (4 feet) or greater
- Place device on a solid, level surface or cart
- Device is not meant to be operated while moving
- Install equipment so that power cord is easily accessible

Table 2: Environmental Specifications for Breezy Blue Response

Product Specification	Description
SKU	BBR01
Electrical Phase	Single
Installation Location	Indoor
Temperature	Operating: 5 °C to 40 °C Storage: 5 °C to 60 °C
Humidity	Operating: ≤ 80% RH: 31 °C Storage: ≤ 80% RH: 31 °C
Altitude	Operating: ≤ 3000 m (9,843 ft) Storage: ≤ 12,000 m (39,370 ft)
Flow Rate	About 13.6 L (3.6 gal) per hour of fogging
Fuse Rating	AC250V, 10A, slow blow
Sound	Up to 116dBA while fogging

Specifications are subject to change without notice.



Power Supply Requirements

WARNING. To reduce the risk of fire and shock, ensure that the main supply voltage fluctuations don't exceed 10% of the operating voltage range.

Table 3: Power Specifications for Breezy Blue Response

AC Input	110-120 VAC (+/- 10%), CAT II
Frequency	50/60Hz (+/- 5%)
Power	1080 W

WARNING. This product is grounded through the grounding conductor of the power cord. To avoid electric shock, the grounding conductor must be connected to earth ground.

WARNING. Do not disable the power cord grounding connection. Without the safety ground connection, all accessible conductive parts may provide an electric shock. Failure to use a properly grounded approved outlet and the included three-conductor AC line power cable may result in injury or death.

Cleaning

Inspect the device as often as operating conditions require. To clean the exterior surface, perform the following steps:

1. Unplug the device to power off.
2. Remove loose dust on the outside of the device with a lint free cloth.
3. Use a soft cloth dampened with water to clean the device. Use an aqueous solution of 70% isopropyl alcohol for more efficient cleaning.
4. Inspect the air intake slots and clean as needed using a vacuum or soft brush.



CAUTION. To avoid surface damage to the device, do not use any abrasive or chemical cleaning agents.

CAUTION. Avoid getting moisture inside the device during external cleaning. Use only enough water/cleaning solution to dampen the cloth or swab.

Powering the Device ON and OFF

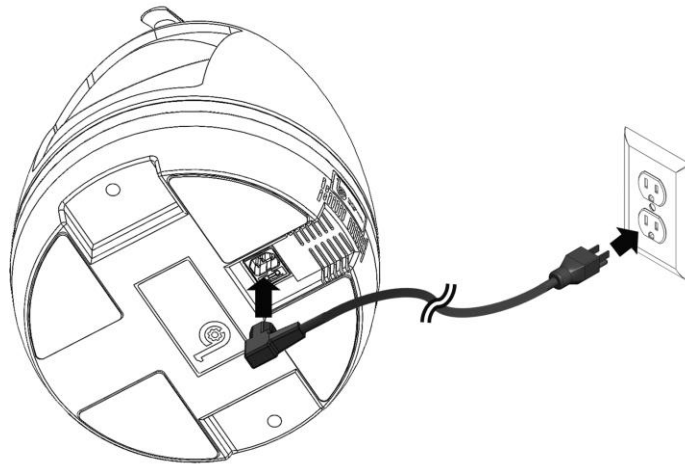

Figure 2: Power Breezy Blue Response on and off (electrical inputs)

The following instructions show how to apply power to the device and turn it on and off. Refer to Figure 1 and 2.

1. **Power On.** Connect the power cord to the underside of the unit and to an electrical outlet. The waist status light will turn either blue or yellow, indicating that the device is powered on.
2. **Power Off.** Disconnect the power cord from the underside of the unit or from the electrical outlet to power off.



Functions and Operating Descriptions

Below are the default settings and instructions for using the unit without the use of a wireless controller (**sold separately**). The unit will provide the user visual and audio status using the mechanisms shown in Table 4. Also see *Fill Port Instructions – Filling the Solution Tank when Low* for more information.

Default Factory Settings

- Push-button mode ENABLED
- Countdown duration: 20 seconds
- Fogging duration: 30 seconds
- Settling duration: 10 minutes
- Alias: serial number







Push Button Operation

(Refer to Figure 1.)

1. Depress the *fogger enable button* (if already depressed, press two times).
 - a. A 20 second countdown to fogging will begin, accompanied by flashing red *status lights* and an audible alert on Breezy Blue during which the area being treated must be cleared of all people, animals, etc.
 - b. A 30 second fogging will begin when the *status lights* turn solid red, and the fogger motor turns on.
 - c. After fogging is complete, the *lower status lights* will flash yellow to indicate the fog settling phase for 10 minutes.
 - d. After the settling is complete the *lower status light* will turn blue, and the area can be opened for fresh air circulation.



Table 4: States and Status Indicators for Breezy Blue Response

Status	LED Ring	Button LEDs	Audio	Status Icon	Breezy Controller Icon
Out of Range of Controller or Off	Any option below or Off	Any Option below		Device Not Found	
During Connection to controller	Any option below	Any Option below		Not Detected	
Idle + Enabled	Blue	Off		Ready to Fog	
Idle + Disabled	Yellow	Yellow		Disabled	
Fogging Countdown	Red, blinking	Red, blinking	[Beep] "Alert, disinfectant fogging will begin soon. Please leave the area or press the disable button."	Fog in 8 sec	
Fogging	Red	Red		Fogging for 5, 15, 30, 45 sec	
Fog Settling	Yellow, blinking	Off		Settling for 10 min	
Firmware updating	White	Off		Progress bar	
Error	White, blinking	Off		Error	



BB01-WC Wireless Controller Setup (Not included with Breezy Blue Response)

It is recommended that you charge the controller fully before use.

Controller navigation overview

Basic controls are the same as an Android phone.



1. The Home button is located at the center-bottom of the screen (left picture above).
2. The App overview button is located at the right-bottom of the screen (right picture above). This button can be used to close the Breezy Blue app if problems are encountered.



Connecting to Wi-Fi

Connecting to Wi-Fi is required for receiving app and firmware updates. App updates will occur automatically if connected to Wi-Fi.

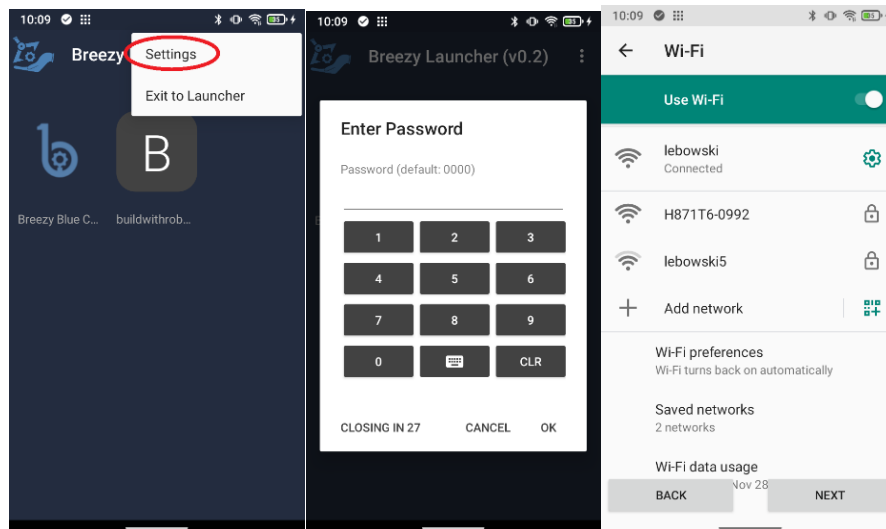

1. Power controller on
2. Select settings from the : icon on the main screen
3. Enter 1234, then press OK
4. Select the Wi-Fi network you would like to connect to, enter the password, and press CONNECT.



Setting screen timeout (optional)

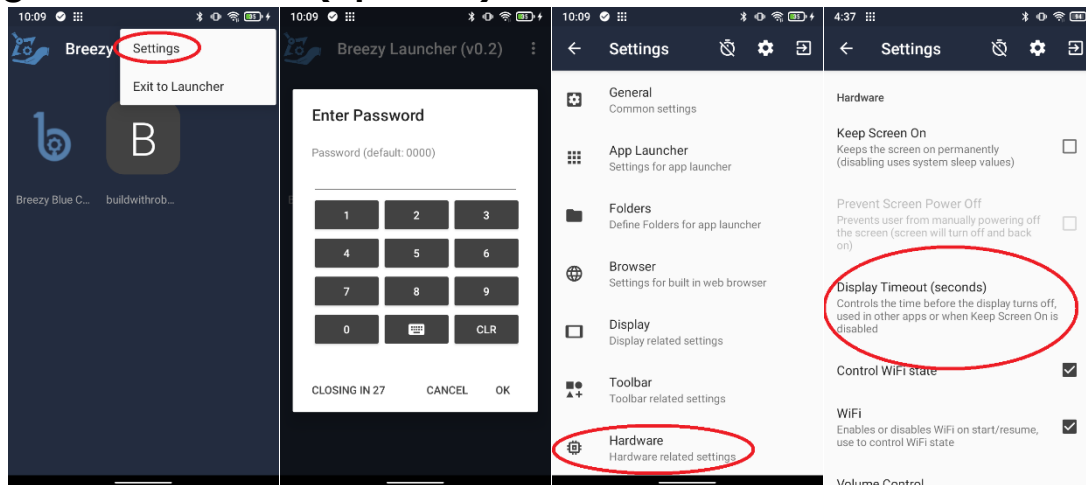

1. Select settings from the **:** icon on the main screen
2. Enter 0000, then press OK
3. Select Hardware
4. Select Display Timeout (seconds)

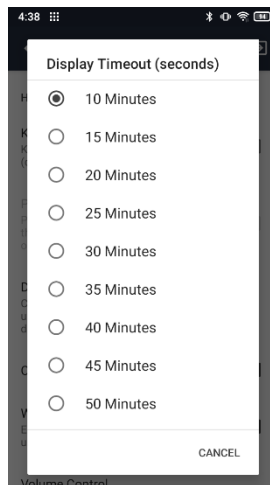

5. Select the preferred display timeout from list of options.



Setting lock screen PIN (optional)

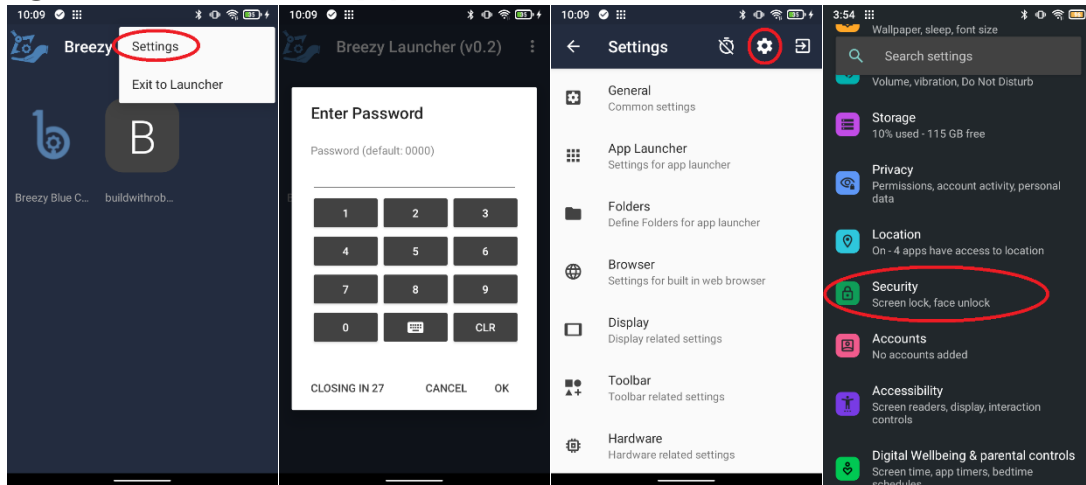

1. Select settings from the : icon on the main screen
2. Enter 0000, then press OK
3. Select the settings gear
4. Select Security

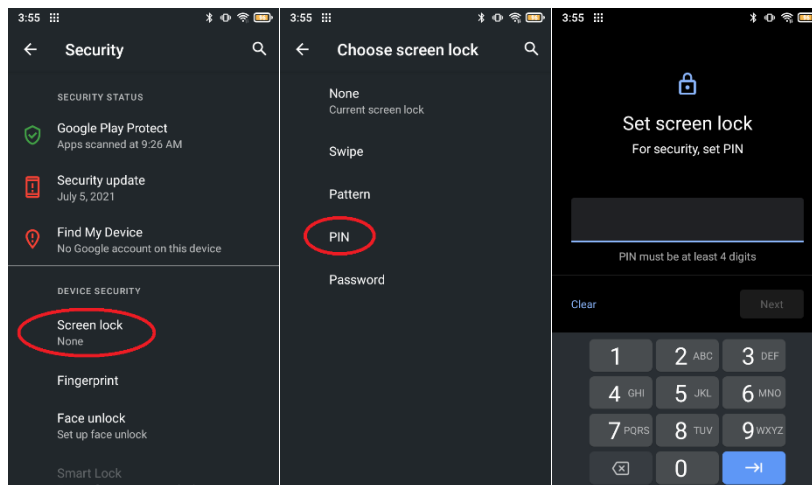

5. Select Screen lock
6. Select PIN (or other options) and follow in screen instructions

If you choose to change the default PIN to a customized PIN, BWR will NOT be able to recover your controller in the event you lose or forget your customized PIN.



Updating Android Kiosk PIN for Wi-Fi and settings (optional)

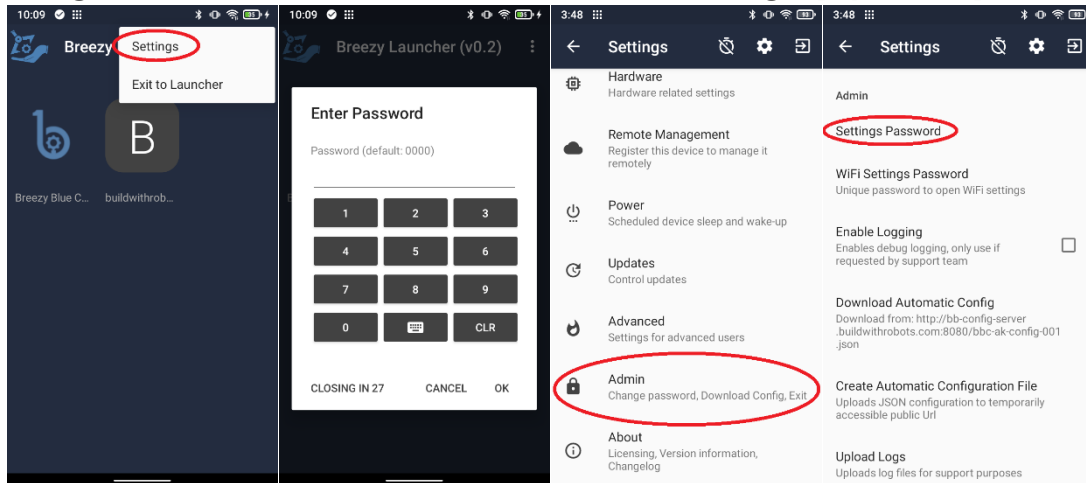

1. Select settings from the : icon on the main screen
2. Enter 0000, then press OK
3. Select Admin
4. Select Settings Password and follow on-screen instruction to set new PIN, then press OK. This PIN is used to configure any system settings on the controller.



5. Select WiFi Settings Password and follow on-screen instructions to set new PIN, then press OK. This PIN is only used for updating WiFi settings on the controller.

If you choose to change the default PIN to a customized PIN, BWR will NOT be able to recover your controller in the event you lose or forget your customized PIN.



Log-in

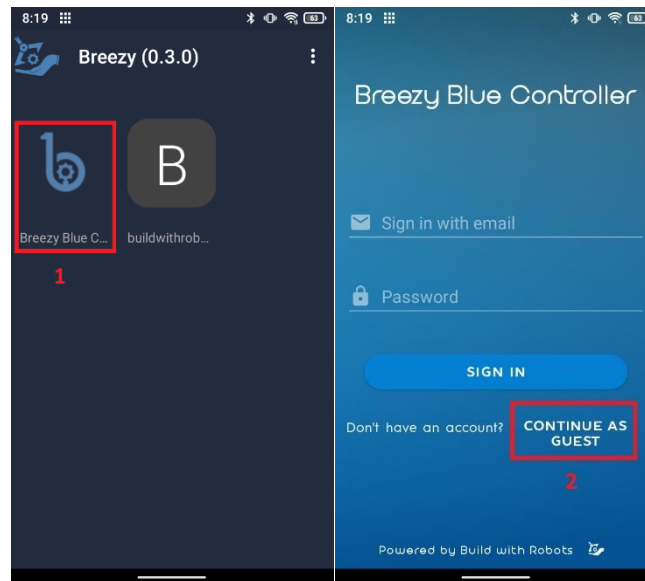



Press the physical home button on the controller.

1. Select the Breezy Blue logo on the upper left-hand side of the screen to open the app – if it doesn't open automatically.
2. Select CONTINUE AS GUEST.

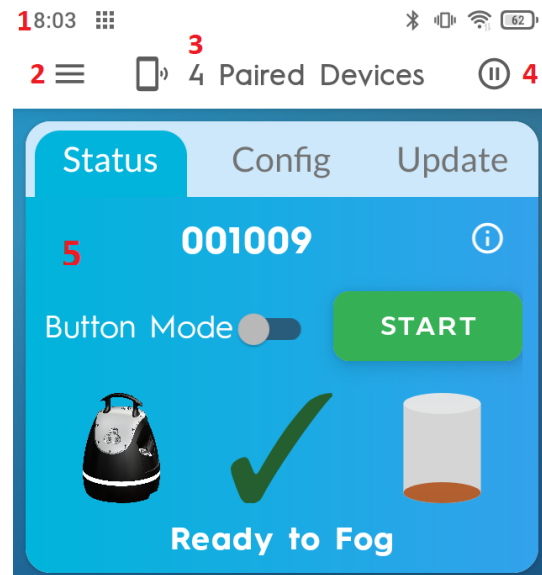

Main Screen Overview



1. Controller clock – The time will automatically update to your local time when the controller is connected to Wi-Fi. Ensure this time is correct before scheduling Breezy Blue fogging events.
2. Available devices  button – Available Breezy Blue devices that are in range but not paired to the controller will be shown when this button is pressed.
3. Number of paired devices – Overview of how many Breezy Blue devices have been paired to the controller. Each device will have a card shown below. Up to five Breezy Blue devices may be paired to a controller at a time.
4. Scan / Pause button – Used to pause and restart a scan for paired devices. This is useful for reconnecting to a paired unit that has disconnected from Bluetooth. Leave as shown for normal operation.
5. Paired Breezy Blue card – Each Breezy Blue that has been paired will display a card with pertinent information and will allow the user to update the Breezy Blue unit settings.



Pairing

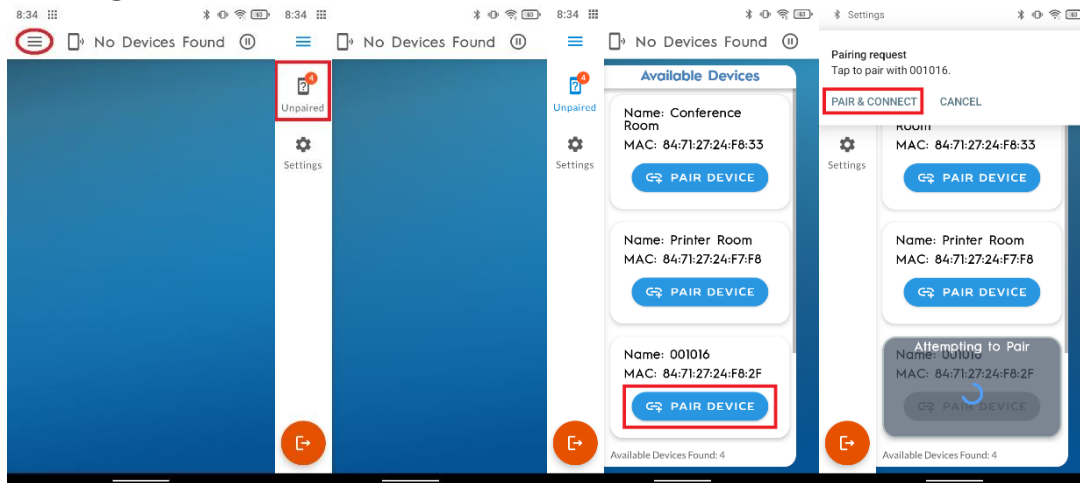

1. Press Available devices  button.
2. Press the Unpaired button to show available devices in range of controller.
3. A list of devices will be shown. Press PAIR DEVICE button on device intended to be paired, in this case 001016.
4. Press PAIR & CONNECT button. If this is not available, return to step 3

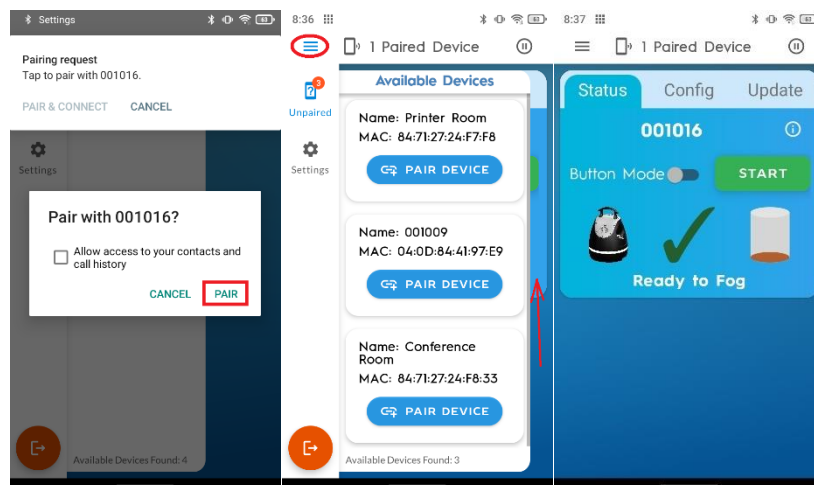

5. Press PAIR button.
6. The screen should be updated to show a device card in the background (see arrow above) and the paired serial number should be removed from the unpaired list.
7. Press the  button to return to the Main Screen



Unpairing

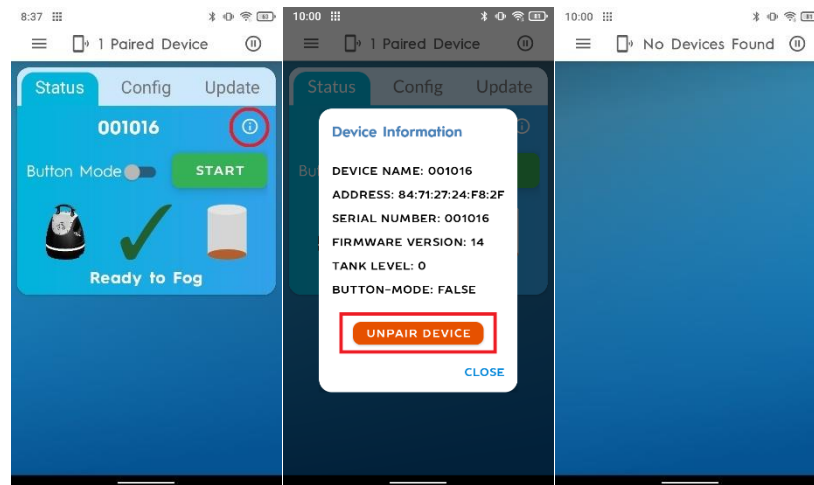

1. Select the information ⓘ icon towards the upper right corner of unit to be unpaired.
2. Press the UNPAIR DEVICE button.
3. The Unpaired unit's card will now be absent from the Main Screen



Status Tab

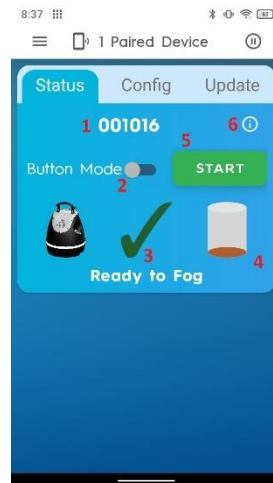

1. Device Alias – For new Breezy Blue units, the alias is configured as the serial number of the device. This can be renamed – see “Config Tab” section below.
2. Push-Button Mode – Enable to use *One-Button Operation* or disable for remote control only operation.
3. Breezy Controller Icon – This is associated with the status of the device. See explanation of icons in Table 4.
4. Tank level – Shown in six increments. A red tank indicator is displayed when empty. See “*Fill Port Instructions*” for instructions on refilling the tank with Build With Robots approved solution.
5. Start / Stop Button – Used to initiate and cancel a fogging event remotely.
6. Device information Button – Displays detailed information about the device including serial number, MAC address and more. It is also used to access the UNPAIR DEVICE button.



Config Tab

Alias Button

Limited to 24 characters. (ex. Class 202, Firehouse 12, Casino 1st floor)

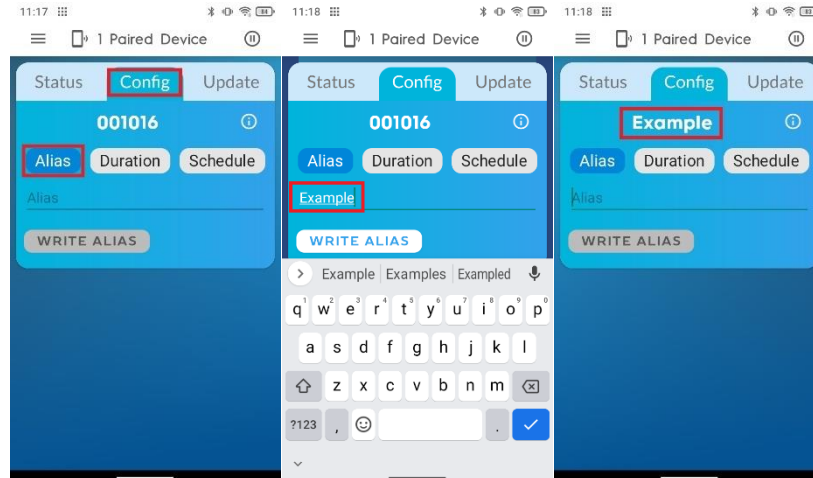

1. Select the Config tab.
2. Select the Alias button.
3. Type new Alias name in the Alias Field
4. Press "WRITE ALIAS" button.
5. The new Alias will be shown on device card – the new alias will persist when the device is unpaired from the controller.



Duration Button

Fogging duration and Countdown duration are both configurable on this tab.

Fogging duration defines the time Breezy Blue dispenses fog in the area.

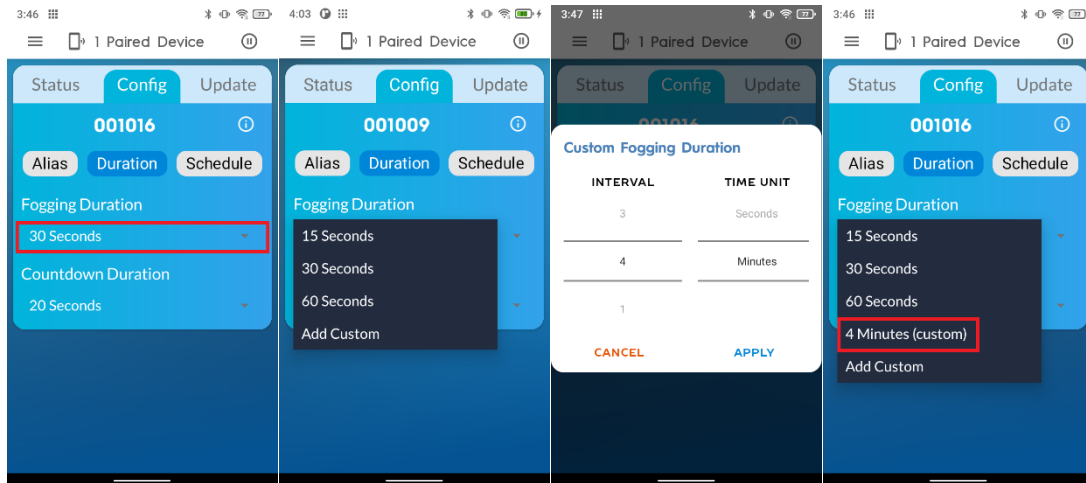

1. Fogging duration is set to 30 seconds at the factory. It can be configured by selecting the fogging duration time dropdown and picking an option from the list.
2. “Add custom” can be selected if the available times don't meet the fogging requirements.
3. A fogging time of up to 4 minutes can be configured using the number dial and selecting minutes or seconds, then pressing “APPLY”
4. The new fogging time can be selected from the list.



Countdown duration defines the time that the Breezy Blue alerts the people in the area that a fogging event will occur and that they should leave the area or press the disable button.

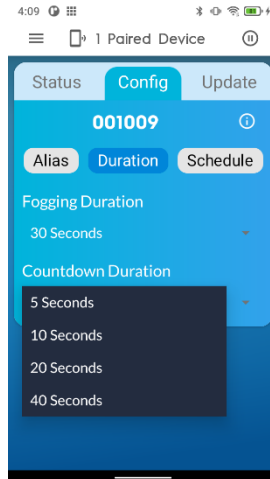

- Countdown duration is set to 20 seconds at the factory. It can be configured by selecting the countdown duration time dropdown and picking an option from the list.



Schedule Button

SYNCHRONIZE TIME aligns the Breezy Blue time with the controller time. This is necessary to ensure the scheduled fogging events occur at the time intended. The Breezy Blue time should be synchronized every few months if it is important to fog at a specific time.

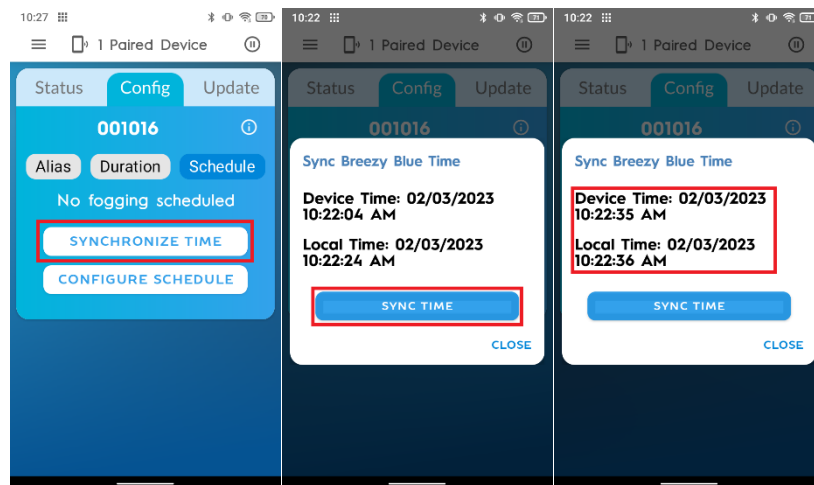

1. Verify the controller time is correct, then press the “SYNCHRONIZE TIME” button.
2. If the reported Device Time (Breezy blue unit) and the Local Time (controller) are not aligned - greater than 30 second difference, press the “SYNCHRONIZE TIME” button
3. After synchronization, the reported times should be within a few seconds of each other.



CONFIGURE SCHEDULE Allows the operator to define a schedule for Breezy Blue to automatically fog up to one occurrence per day

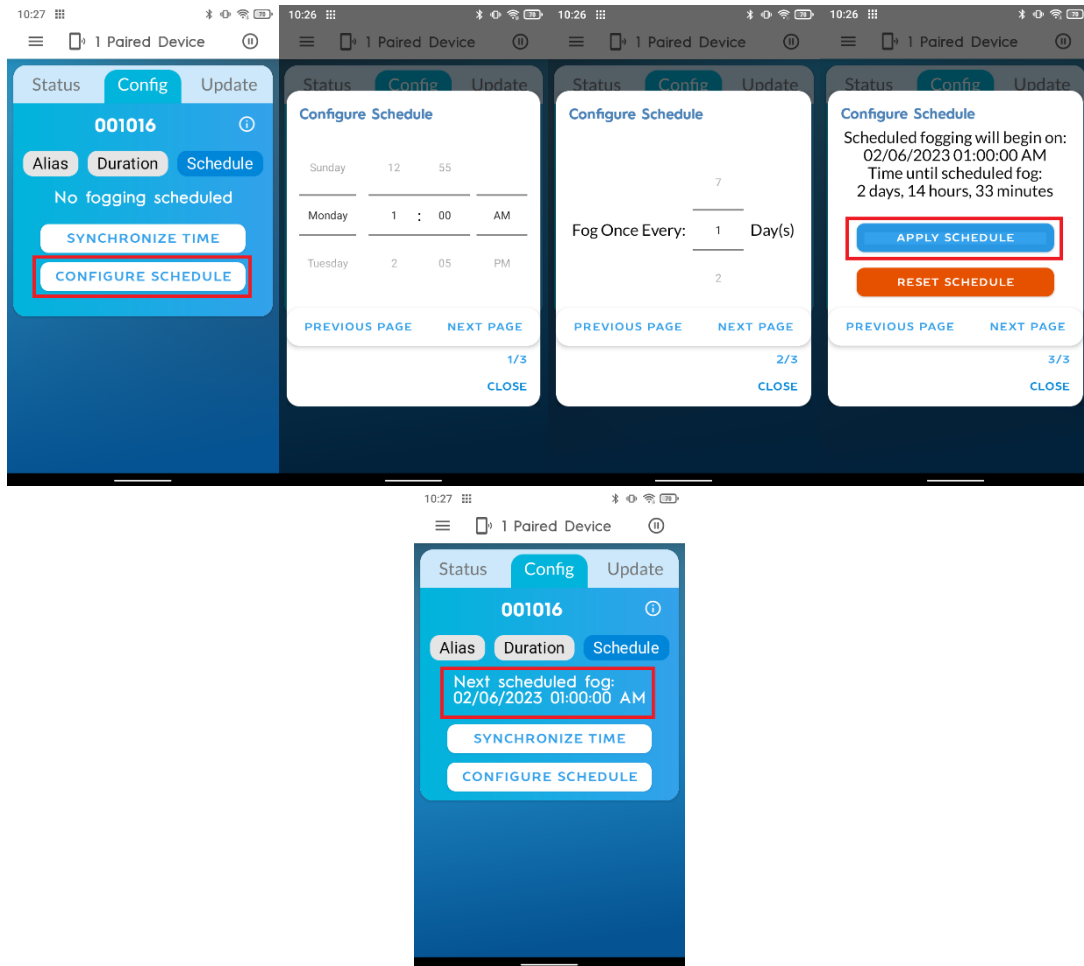

1. On the Config tab, press the “CONFIGURE SCHEDULE” button
2. Select the day on the week that the schedule should start.
3. Select the time of the day that the fogging event should take place and press the “NEXT PAGE” button.
4. Select how often the fogging event should take place.
Example: If 1 is selected, fogging will take place every day.
If 3 is selected, fogging will take place every 3rd day. Press “NEXT PAGE” button
5. Press “APPLY SCHEDULE” button if the schedule looks appropriate and the schedule will be shown on the config tab when Schedule is selected.



RESET SCHEDULE Allows the operator to clear the existing schedule so the Breezy Blue will no longer fog on a regular schedule

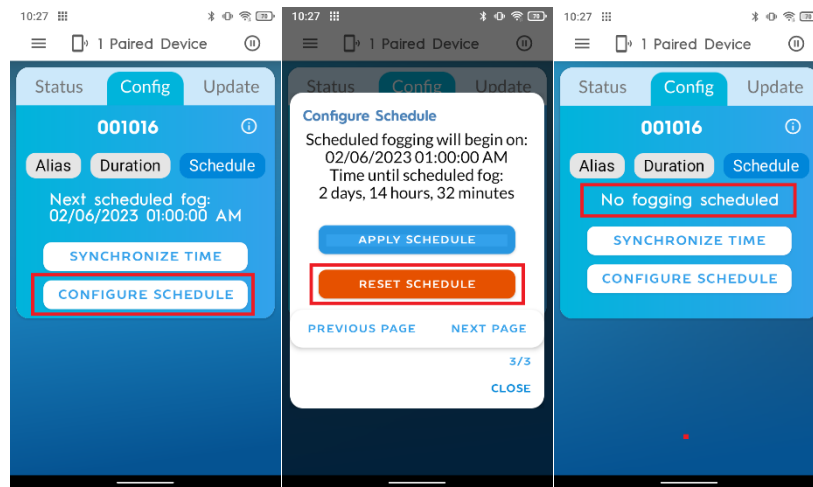

1. On the Config tab, press the “CONFIGURE SCHEDULE” button
2. On the Configure Schedule screen press the “RESET SCHEDULE” button
3. The screen should return to the config tab and show “No fogging scheduled.”



Update Tab

If connected to Wi-Fi, the controller will automatically update the app as new versions are released. The updated app may also include a firmware update that can be applied to each Breezy Blue unit using the instructions below.

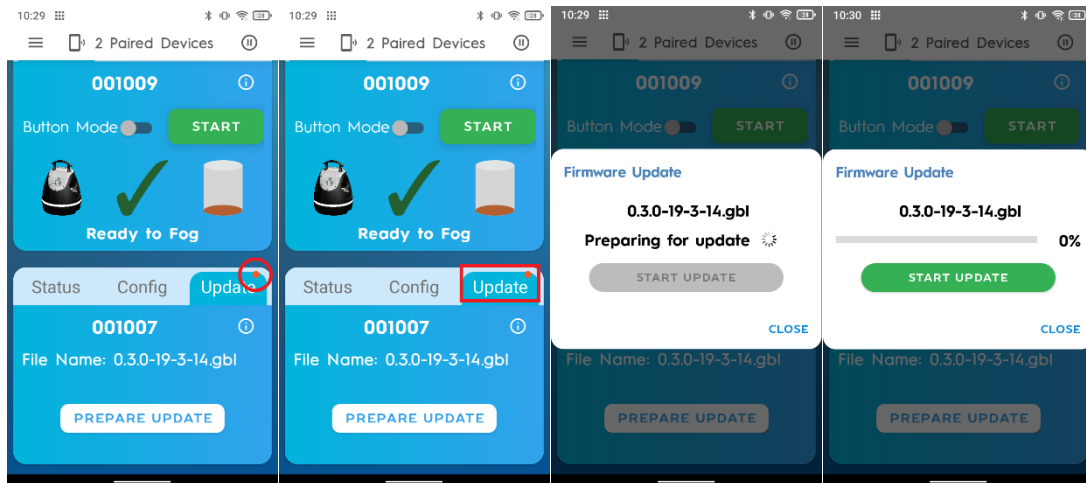

1. Breezy Blue units requiring a firmware update will show a red dot on the update tab
2. Select the update tab and press the “PREPARE UPDATE” button – this button will not be selectable if there are no updates available.
3. The screen will advise the unit is preparing for update.
4. Press the “START UPDATE” button when it is available on the screen.
5. Wait for the update to finish. During this time, the controller needs to stay near the Breezy Blue unit the display needs to be on. The update should take a few minutes.



Remote Controlled Operation

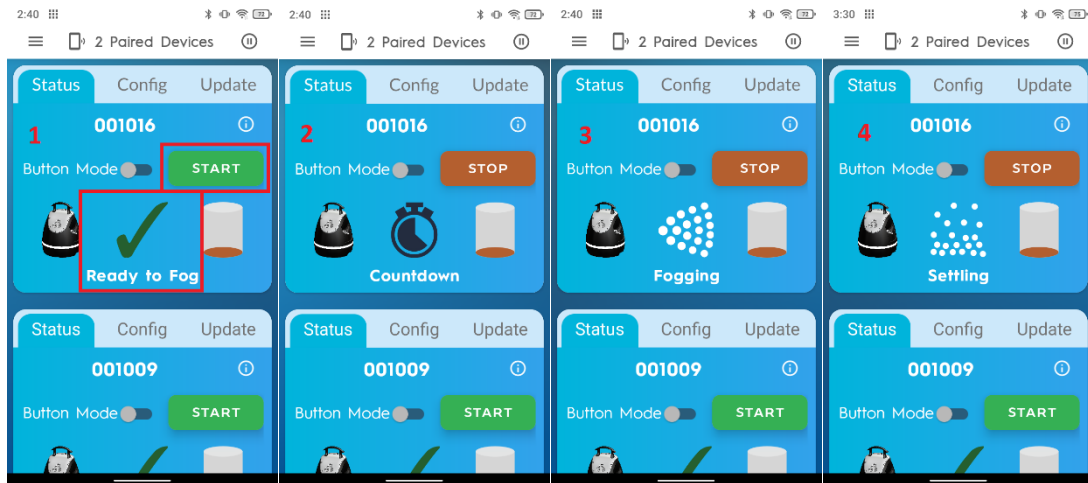

1. Verify the Breezy Blue unit to be fogged displays “Ready to Fog” on the controller display, then press the “START” button.
2. A 20 second (default) countdown to fogging will initiate. The Breezy Blue waistband light will flash red and there will be an audible warning to leave the area. Press the “STOP” button on the controller or the “DISABLE” button on the Breezy Blue unit to cancel the fogging event.
3. When the countdown ends, a 30 second (default) fogging event will begin. The Breezy Blue waistband will turn solid red. Press the “STOP” button on the controller or the “DISABLE” button on the unit to cancel the fogging event.
4. After fogging has completed, the Breezy Blue unit will enter a 10-minute fog settling time indicated by a flashing yellow light on the waistband.
5. When settling has completed, the Breezy Blue waistband will return to a blue color and the controller will report “Ready to Fog”. At this time, the area can be opened for ventilation and the HVAC system can be turned on to prepare the area for re-entry. For more information on when the room is safe to re-enter, refer to the Breezy Biocare Instructions for Use document.



Approved BWR Solutions

Safety and operational information, including fogging and fog settling times using BWR approved solutions, can be found at <https://buildwithrobots.com/breezy-biocare-rtu>.

Fill Port Instructions

Filling the Solution Tank from Empty

1. Unscrew the fill port cap.
2. Ensure the screen filter is in place and free of debris.



3. Pour up to 3.8L (1 gal) of Build With Robots approved solution into tank. Stop filling if solution level is visible in the screen filter. Do not overfill
4. Replace the fill port cap.

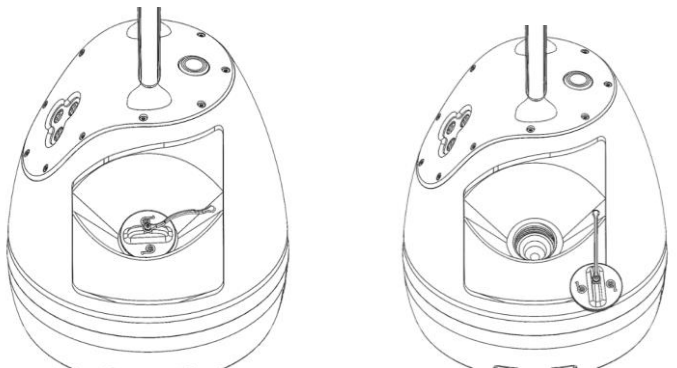

Filling the Solution Tank When Solution Level is Low

1. Unscrew the fill port cap.
2. Ensure screen filter is in place and free of debris
3. Slowly pour up to 3.8L (1 gal) of Build With Robots approved solution into tank until the tank icon on the controller shows the tank is full or if solution level is visible in the screen filter*. Do not overfill.

*Note - without the Breezy Blue controller, the user will not be able to view the level of the solution in the tank. The user can temporarily remove the screen filter to visually check the fluid level in the tank. Be sure to replace the screen filter before filling the unit or replacing the fill port cap.

Emptying the Solution Tank

In the case that the solution in the tank needs to be emptied, power off the unit, remove the fill port cap and screen filter and tip the unit so the fill port is at the lowest elevation possible. Be sure to properly dispose of the solution removed from the tank (refer to solution SDS).



Troubleshooting

Table 5: Breezy Blue Troubleshooting

PROBLEM	POSSIBLE CAUSES	SOLUTION
Waist band light does not illuminate	Unit is not powered	Ensure unit is fully plugged in both at the power input module on the underside of the unit and at the outlet, and that the outlet is working
	Damaged fuse	Replace fuse in socket next to power cord
	Other	Unplug and re-plug in the unit
Fogger motor won't turn on when started from app, but lights are illuminated on unit	Fogger disable switch is in the up position (un-depressed)	Make sure switch is in the down (depressed) position
Fogger motor turns on, but fog does not come out	Solution level is too low	Refill solution
	Air intake ports are blocked	Ensure that air intake ports on rear and underside of unit are clean and clear of obstruction
Excessive moisture builds up on unit or surrounding area after fogging	Build-up or obstruction at the fogger intake or output ports	Clean air intake at rear of unit and all three fogger output ports with a damp cloth and remove any obstructions



Maintenance

Table 6: Breezy Blue Scheduled Maintenance

Part	Clean/Replace
Fill port screen filter	Remove and clean fill port screen filter every 10 gallons of solution or when contaminated using water and a soft brush
Exterior	Wipe down exterior of unit monthly using a cloth wetted with water or 70% isopropyl alcohol
Synchronize time	If using the scheduling feature, Synchronize Breezy Blue with the controller time every three months or as needed.
Firmware update	Check for and install firmware updates monthly using the Breezy Blue wireless controller



LIMITED WARRANTY (USA/CANADA)

Build With Robots warrants that this product will be free from defects in materials and workmanship for a period of one (1) year from the date of shipment. If any such product proves defective during this warranty period, Build With Robots, at its option, either will repair the defective product without charge for parts and labor, or will provide a replacement in exchange for the defective product. Parts, modules and replacement products used by Build With Robots for warranty work may be new or reconditioned to like new performance. All replaced parts, modules and products become the property of Build With Robots.

In order to obtain service under this warranty, Customer must notify Build With Robots of the defect before the expiration of the warranty period and make suitable arrangements for the performance of service. Customer shall be responsible for packaging and shipping the defective product to the service center designated by Build With Robots, with shipping charges prepaid. Build With Robots shall pay for the return of the product to Customer if the shipment is to a location within the country in which the Build With Robots service center is located. Customer shall be responsible for paying all shipping charges, duties, taxes, and any other charges for products returned to any other locations.

This warranty shall not apply to any defect, failure or damage caused by improper use or improper or inadequate maintenance and care. Build With Robots shall not be obligated to furnish service under this warranty a) to repair damage resulting from attempts by personnel other than Build With Robots representatives to install, repair or service the product; b) to repair damage resulting from improper use or connection to incompatible equipment; c) to repair any damage or malfunction caused by the use of non-Build With Robots supplies; or d) to service a product that has been modified or integrated with other products.

THIS WARRANTY IS GIVEN BY BUILD WITH ROBOTS WITH RESPECT TO THE PRODUCT IN LIEU OF ANY OTHER WARRANTIES, EXPRESS OR IMPLIED. BUILD WITH ROBOTS AND ITS VENDORS DISCLAIM ANY IMPLIED WARRANTIES OF MERCHANTABILITY OR FITNESS FOR A PARTICULAR PURPOSE. BUILD WITH ROBOTS' RESPONSIBILITY TO REPAIR OR REPLACE DEFECTIVE PRODUCTS IS THE SOLE AND EXCLUSIVE REMEDY PROVIDED TO THE CUSTOMER FOR BREACH OF THIS WARRANTY. BUILD WITH ROBOTS AND ITS VENDORS WILL NOT BE LIABLE FOR ANY INDIRECT, SPECIAL, INCIDENTAL, OR CONSEQUENTIAL DAMAGES IRRESPECTIVE OF WHETHER BUILD WITH ROBOTS OR THE VENDOR HAS ADVANCE NOTICE OF THE POSSIBILITY OF SUCH DAMAGES.

